

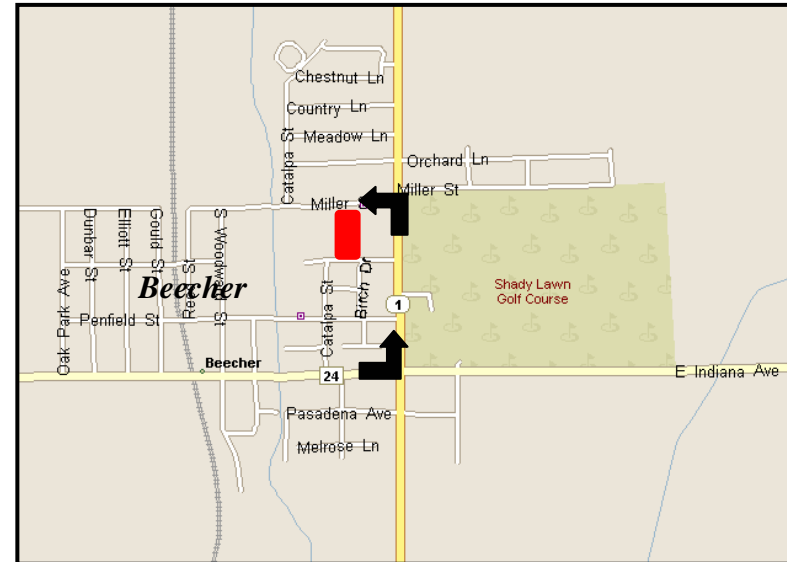

BEECHER

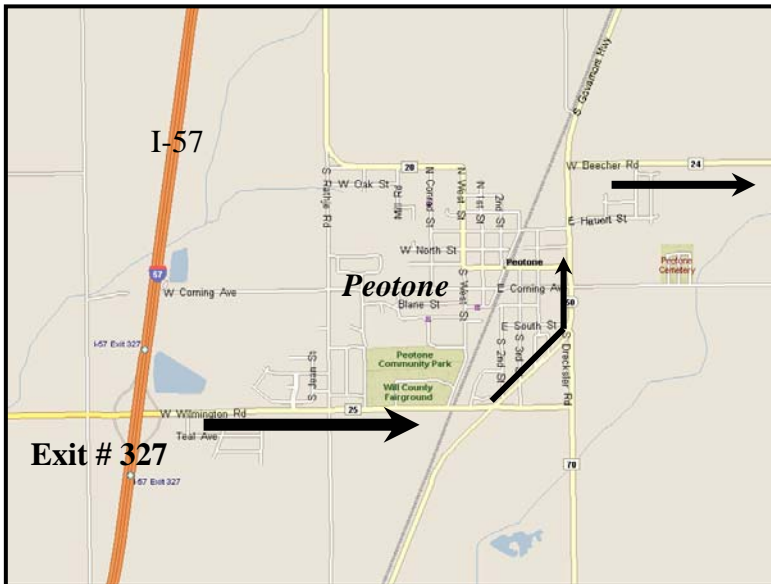

Route to Beecher: From Champaign take Interstate-57 NORTH past Kankakee. Continue north on I-57 to the Peotone exit (**Exit # 327**) which is about 92 miles from Champaign. Turn right (east) onto W. Wilmington Road (aka County Road 24) and proceed east about 1.3 mile. Turn left (northeast and north) onto Illinois Route 50 (Governors Highway) for about 1.1 mile. Then, right (east) onto Beecher Road (which turns into Indiana Avenue) and travel east for 8.5 miles.

Turn left (north) onto IL Route 1 for 3 blocks. Left again (west) onto Miller Street.